



ABODE HOTELS CANBERRA PTY LTD
ABN: 81 041 402 610

ABODE WODEN
(02) 6108 4950
10 Bowes Street WODEN ACT 2606

PO Box 4519 KINGSTON ACT 2604
P 1300 1 ABODE (22633)
W abodehotels.com.au

DISHWASHER

Please see the following operational guidelines to ensure optimal usage of the dishwasher:

Date: 11 November 2023

Operating instructions - Starting a wash

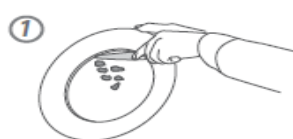

1 Discard scraps

Scrape large food particles off (e.g. bones, fruit stones) and remove any foreign objects (e.g. toothpicks, strings, paper).

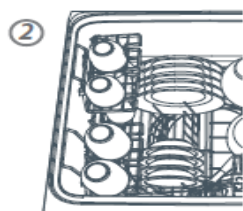

2 Load dishes carefully

To help with wash performance, arrange dishes so they are evenly spaced and not nesting.



3 Check spray arm(s)

Ensure there are no items blocking the spray arm(s) from rotating.

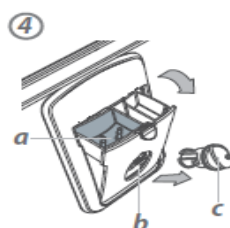

4 Add detergent and check rinse aid

Fill the detergent dispenser (a) with powdered detergent and close the dispenser door.

Important!

Do not place liquid detergent or tablets in the detergent dispenser.

If the indicator on its plug (c) glows bright red, refill the rinse aid dispenser (b) with liquid rinse aid. Make sure you then refit the rinse aid plug back into its original position.

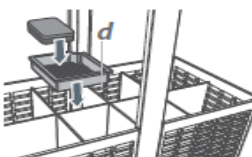

If using a tablet, place it in the cutlery basket (d) or at the bottom of the drawer.



5

HEAVY NORMAL FAST DELICATE RINSE ECO

Select wash

Power the dishwasher on  then select wash program .

6



Start wash or set Delay start

Close the drawer and press .

Exclusive Dishwashing Powder: It is essential to utilise the designated Dishwashing Powder provided by the hotel. This ensures an optimal cleaning process.

Enhanced Drying Option: Should you desire heightened dish drying results, kindly coordinate with our Front Office team to acquire the appropriate Rinse Aid solution. This is suitable for items such as glassware.

Important Notes.

- Please refrain from using dishwashing liquid in this dishwasher. Only the provided dishwashing Powder is suitable for this appliance. The dishwashing liquid supplied is intended exclusively for manual handwashing purposes. Dishwashing powder and liquid are available at reception 24/07.
- Please do not hesitate to seek our help if you require further assistance.