



ABODE HOTELS CANBERRA PTY LTD
ABN: 81 041 402 610

ABODE WODEN
(02) 6108 4950
10 Bowes Street WODEN ACT 2606

PO Box 4519 KINGSTON ACT 2604
P 1300 1 ABODE (22633)
W abodehotels.com.au

WASHING MACHINE DRYER COMBO

Please see the following operational guidelines to ensure optimal usage of the washing machine dryer combo:

Date: November 2023

- 1 Detergent dispenser drawer
- 2 Control panel
- 3 Door opening handle
- 4 Drain pump
- 5 Adjustable feet

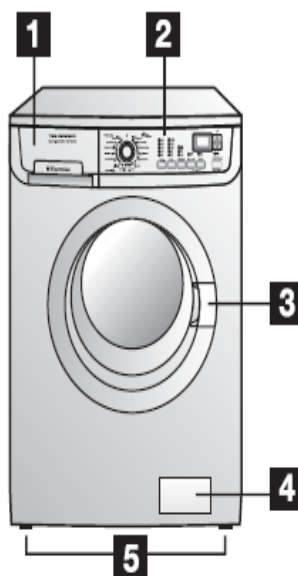

Detergent dispenser drawer

- Prewash
- Wash
- Fabric Softener

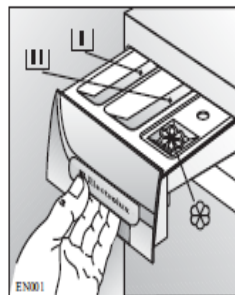

Control panel

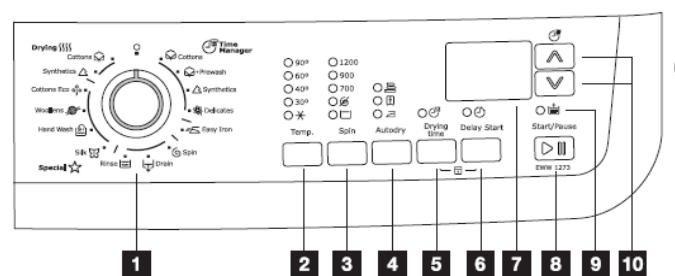

- 1 Programme selector dial
- 2 Temperature button
- 3 Spin Reduction button
- 4 Autodry button
- 5 Drying time button
- 6 Delay Start button
- 7 Display
- 8 Start/Pause button
- 9 Extra Rinse pilot light
- 10 Time Manager button

Symbols

- Cottons , Prewash , Synthetics , Delicates , Easy Iron , Spin , Drain , Rinse , Silk , Hand Wash , Woollens , Cottons Eco
- Drying , Extra dry , Store dry , Iron dry , Drying Time , Delay Start , Rinse Hold , No Spin , Cold , Extra Rinse , Time Manager



ABODE HOTELS CANBERRA PTY LTD
ABN: 81 041 402 610

ABODE WODEN
 (02) 6108 4950
 10 Bowes Street WODEN ACT 2606

PO Box 4519 KINGSTON ACT 2604
P 1300 1 ABODE (22633)
W abodehotels.com.au

Daily Use - Washing



Load the laundry

Open the door by carefully pulling the door handle outwards. Place the laundry in the drum, one item at a time, shaking them out as much as possible. Close the door.



Measure out the detergent and the fabric softener

Pull out the dispenser drawer until it stops. Measure out the amount of detergent required, pour it into the main wash compartment (1), and, if you wish to carry out the "prewash" phase, pour it into the compartment marked (2).

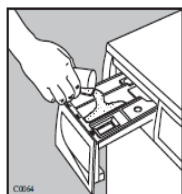

If required, pour fabric softener into the compartment marked (3) (the amount used must not exceed the "MAX" mark in the drawer). Close the drawer gently.

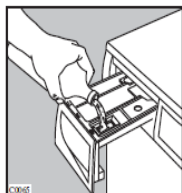

Select the required programme

Turn the programme selector dial to the required programme. The Start/Pause light starts to flash and the Display shows the duration of the selected programme.



The selector dial is divided into following sections:

- Cottons (Cottons), Prewash, Synthetics, Delicates
- Easy Iron
- Spin, Drain, Rinse
- Silk, Hand Wash, Woollens, Cottons Eco
- Synthetics, Cottons (Drying)

The selector dial can be turned either clockwise or anticlockwise. Position (O) to Reset programme/ Switching OFF of the machine.

At the end of the programme the selector dial must be turned to position O, to switch the machine off.

Attention!

If you turn the programme selector dial to another programme when the machine is working, the red Start/Pause pilot light will flash 3 times and the message **Err** will appear on the display to indicate a wrong selection. The machine will not perform the new selected programme.

Programme Option buttons

Depending on the programme, different functions can be combined. These must be selected after choosing the desired programme and before depressing the Start/Pause button. When these buttons are pressed, the corresponding pilot lights come on. When they are pressed again, the pilot lights go out.

Select the temperature

- 90°C
- 60°C
- 40°C
- 30°C
- Temp.



Press this button repeatedly to increase or decrease the temperature, if you want your laundry to be washed at a temperature different from the one proposed by the washer-dryer machine. Maximum temperatures are 90°C for Cottons, Cottons Prewash, Cottons Eco and 60°C for Synthetics, Easy iron programmes; 40°C for Delicates, Hand Wash, Woollens and 30°C for Silk programmes.

Select the Spin Speed, No Spin or Rinse Hold option

- 1200
- 900
- 700
- Spin



Press the Spin button repeatedly to change the spin speed, if you want your laundry to be spun at a speed different from the one proposed by the washer-dryer machine.

The relevant light will light up. Maximum speeds are:

- for Cottons, Cottons Prewash and Cottons Eco: 1200 rpm;
- for Synthetics, Easy Iron, Hand Wash, and Woollens: 900 rpm;
- for Delicates and Silk: 700 rpm.
- if you don't need your laundry to be spun in the final process, you can select to (No Spin) programme.

To empty out the water:

- turn the programme selector dial to "O"
- select the (Drain) or (Spin) programme
- reduce the spin speed if needed, by means of the relevant button
- press Start/Pause button
- at the end of the programme, the display shows a 0.00 flashing. The door can be opened.

Rinse Hold (): by selecting this option the water of the last rinse is not emptied out to prevent the fabrics from creasing. When the programme has finished the display shows a 0.00 flashing, the Start/Pause light is off and the door is locked to indicate that the water must be emptied out.

To empty out the water, please read the previous option steps.

Select the Autodry

By pressing this button you can choose the required degree of drying for cottons and synthetics:

Extra dry (Cottons)

Store dry (Cottons and Synthetics)

Iron dry (Cottons)

The relevant light will light up.

The drying time is automatically adjusted by the machine: the laundry will be dried to the selected dryness degree.

Select the Drying time

If you wish to carry out a timed drying programme, press this button until the drying time you want appears on the display according to the fabrics (cottons or synthetics) you have to dry.

For **Cottons** you can select a drying time from 10 minutes to 250 minutes (4.10).

For **Synthetics** you can select a drying time from 10 minutes to 130 minutes (2.10).

Every time you press this button the drying time increases by 5 mins.

This option is not available with the Delicates, Easy Iron, Spin, Drain, Rinse, Silk, Hand Wash and Woollens programme.

Use - Drying



Drying only

Warning! Do not exceed the following laundry loads:

- 3.5 kg for linen and cottons
- 2.0 kg for synthetics

Loads of washed laundry exceeding these values must be divided before being dried, otherwise poor results will be obtained.

The water tap must be open and the drain hose must be positioned in the sink or connected to the drain pipe.

1. Load the laundry.

2. Select the drying programme (for Cottons (Cottons) or Synthetics (Synthetics) sector).

3. Depress the "Drying time" button until the time you want appears on the display (see the drying programmes). If you wish to carry out the electronic drying, press the "Autodry" button until the pilot light corresponding to the required dryness degree lights up.

4. Press the "Start/Pause" button to start the programme.

5. At the end of the programme, the buzzer sounds. Three flashing zeros "0.00" appear on the display. At this point, begins the anti-crease phase which lasts for about 10 minutes. During this time the door cannot be opened.

Note!

If you wish to open the door before or during the anti-crease phase or to interrupt it, press any button or turn the programme selector dial to any programme position (except "O"), the door can be immediately opened.

6. Turn the selector dial to the "O" position to switch the machine off. Remove the laundry.

Automatic washing and drying (NON-STOP programme)



For NON-STOP programmes, it is also essential not to exceed the maximum load sizes of 3.5 kg for cotton and 2.0 kg for synthetics.

Do not use a dosing device/ball when carrying out a washing & drying programme.

1. Load the laundry.

2. Add detergent and fabric softener.

3. Switch the machine on by turning the selector dial to the selected washing programme/fabric.

4. Select the required options by pressing the relevant buttons. If possible, do not select a spin speed lower than that proposed by the appliance to avoid a too long drying time so saving energy.

In any case the reduction of the spin speed is only possible after selecting drying.



ABODE HOTELS CANBERRA PTY LTD
ABN: 81 041 402 610

ABODE WODEN
(02) 6108 4950
10 Bowes Street WODEN ACT 2606

PO Box 4519 KINGSTON ACT 2604
P 1300 1 ABODE (22633)
W abodehotels.com.au

The lowest values you can select are the following:

with autodry: 900 r.p.m. for cottons and synthetics

with timed drying: 900 r.p.m. for cottons and 700 r.p.m. for synthetics

5. Select the drying time or dryness degree.
6. Start the programme by pressing the "Start/Pause" button.
7. At the end of the programme turn the selector dial to the "O" position to switch the machine off.
8. Remove the laundry.

Duration of the drying cycle

The drying time can vary according to

- the final spin speed;
- the required degree of drying (extra dry, store dry or iron dry);
- the type of laundry;
- the size of load.

The usual drying times for the timed programmes are indicated in the programme chart. As you become more familiar with the appliance, you will discover the drying times that best suit your needs according to the various type of fabric. It is a good idea to make a note of these times.

Fibre residue

After drying fluffy fabrics, such as new towels, it is advisable to perform the programme "Rinses" to be sure that any residue that may remain in the tub is completely removed and does not stick to garments dried afterwards.

After each drying cycle the drain pump filter please refer care and cleaning.

Additional drying

Should the laundry still be too wet at the end of the programme, set another short drying cycle.

Warning! To prevent the formation of creases or shrinking of fabrics, avoid excessive drying.

Important notes

- Please only use the laundry liquids provided by the hotel during the washing cycle. This ensures optimal performance and prevents any undesired outcomes. Washing liquid is available at reception 24/07.
- Please Do Not exert force to open the door. Variations in temperature and water utilization might occasionally lead to a slight delay in door release.
- Please do not hesitate to seek our help if you require further assistance.